















# INSULATED METAL PANELS & ENVELOPE SOLUTIONS PRODUCT OVERVIEW



# Insulated Metal Panels

## FLAT WALL PANELS POLYURETHANE CORE

																																																				
	ARCHITECTURAL	TUFF-CAST™ PRECAST CONCRETE FINISHED LOOK	TUFF WALL® MASONRY LOOK OF STUCCO	SANTA FE®																																																
CROSS SECTION																																																				
SIDE JOINT DETAILS																																																				
WIDTH	24', 30', 36'	36', 42'	36', 42'	36', 42'																																																
THICKNESS	2", 2½", 3", 4"	2", 2½", 3", 4", 5**, 6** <small>**Requires Mesa Profile</small>	2", 2½", 3", 4", 5**, 6** <small>**Requires Mesa Profile</small>	2", 2½", 3", 4" <small>2¾" available from Nevada plant</small>																																																
LENGTH	8'-0" to 32'-0"	8'-0" to 40'-0"	8'-0" to 40'-0"	8'-0" to 40'-0"																																																
75° CORE MEAN TEMP U-FACTOR (BTU/h-ft²-°F)	<table border="1"> <thead> <tr> <th colspan="2">PANEL WIDTH: 36"</th> </tr> <tr> <th colspan="2">75°</th> </tr> </thead> <tbody> <tr> <td>2"</td> <td>0.0669</td> </tr> <tr> <td>2½"</td> <td>0.0500</td> </tr> <tr> <td>3"</td> <td>0.0400</td> </tr> <tr> <td>4"</td> <td>0.0307</td> </tr> </tbody> </table>	PANEL WIDTH: 36"		75°		2"	0.0669	2½"	0.0500	3"	0.0400	4"	0.0307	<table border="1"> <thead> <tr> <th colspan="2">PANEL WIDTH: 36"</th> </tr> <tr> <th colspan="2">75°</th> </tr> </thead> <tbody> <tr> <td>2"</td> <td>0.0669</td> </tr> <tr> <td>2½"</td> <td>0.0500</td> </tr> <tr> <td>3"</td> <td>0.0400</td> </tr> <tr> <td>4"</td> <td>0.0307</td> </tr> </tbody> </table>	PANEL WIDTH: 36"		75°		2"	0.0669	2½"	0.0500	3"	0.0400	4"	0.0307	<table border="1"> <thead> <tr> <th colspan="2">PANEL WIDTH: 36"</th> </tr> <tr> <th colspan="2">75°</th> </tr> </thead> <tbody> <tr> <td>2"</td> <td>0.0669</td> </tr> <tr> <td>2½"</td> <td>0.0500</td> </tr> <tr> <td>3"</td> <td>0.0400</td> </tr> <tr> <td>4"</td> <td>0.0307</td> </tr> </tbody> </table>	PANEL WIDTH: 36"		75°		2"	0.0669	2½"	0.0500	3"	0.0400	4"	0.0307	<table border="1"> <thead> <tr> <th colspan="2">PANEL WIDTH: 36"</th> </tr> <tr> <th colspan="2">75°</th> </tr> </thead> <tbody> <tr> <td>2"</td> <td>0.0669</td> </tr> <tr> <td>2½"</td> <td>0.0500</td> </tr> <tr> <td>3"</td> <td>0.0400</td> </tr> <tr> <td>4"</td> <td>0.0307</td> </tr> </tbody> </table>	PANEL WIDTH: 36"		75°		2"	0.0669	2½"	0.0500	3"	0.0400	4"	0.0307
PANEL WIDTH: 36"																																																				
75°																																																				
2"	0.0669																																																			
2½"	0.0500																																																			
3"	0.0400																																																			
4"	0.0307																																																			
PANEL WIDTH: 36"																																																				
75°																																																				
2"	0.0669																																																			
2½"	0.0500																																																			
3"	0.0400																																																			
4"	0.0307																																																			
PANEL WIDTH: 36"																																																				
75°																																																				
2"	0.0669																																																			
2½"	0.0500																																																			
3"	0.0400																																																			
4"	0.0307																																																			
PANEL WIDTH: 36"																																																				
75°																																																				
2"	0.0669																																																			
2½"	0.0500																																																			
3"	0.0400																																																			
4"	0.0307																																																			
75° CORE MEAN TEMP R-VALUE (h-ft²-°F/BTU)	<table border="1"> <thead> <tr> <th colspan="2">PANEL WIDTH: 36"</th> </tr> <tr> <th colspan="2">75°</th> </tr> </thead> <tbody> <tr> <td>2"</td> <td>14.95</td> </tr> <tr> <td>2½"</td> <td>20.00</td> </tr> <tr> <td>3"</td> <td>25.00</td> </tr> <tr> <td>4"</td> <td>32.57</td> </tr> </tbody> </table>	PANEL WIDTH: 36"		75°		2"	14.95	2½"	20.00	3"	25.00	4"	32.57	<table border="1"> <thead> <tr> <th colspan="2">PANEL WIDTH: 36"</th> </tr> <tr> <th colspan="2">75°</th> </tr> </thead> <tbody> <tr> <td>2"</td> <td>14.95</td> </tr> <tr> <td>2½"</td> <td>20.00</td> </tr> <tr> <td>3"</td> <td>25.00</td> </tr> <tr> <td>4"</td> <td>32.57</td> </tr> </tbody> </table>	PANEL WIDTH: 36"		75°		2"	14.95	2½"	20.00	3"	25.00	4"	32.57	<table border="1"> <thead> <tr> <th colspan="2">PANEL WIDTH: 36"</th> </tr> <tr> <th colspan="2">75°</th> </tr> </thead> <tbody> <tr> <td>2"</td> <td>14.95</td> </tr> <tr> <td>2½"</td> <td>20.00</td> </tr> <tr> <td>3"</td> <td>25.00</td> </tr> <tr> <td>4"</td> <td>32.57</td> </tr> </tbody> </table>	PANEL WIDTH: 36"		75°		2"	14.95	2½"	20.00	3"	25.00	4"	32.57	<table border="1"> <thead> <tr> <th colspan="2">PANEL WIDTH: 36"</th> </tr> <tr> <th colspan="2">75°</th> </tr> </thead> <tbody> <tr> <td>2"</td> <td>14.95</td> </tr> <tr> <td>2½"</td> <td>20.00</td> </tr> <tr> <td>3"</td> <td>25.00</td> </tr> <tr> <td>4"</td> <td>32.57</td> </tr> </tbody> </table>	PANEL WIDTH: 36"		75°		2"	14.95	2½"	20.00	3"	25.00	4"	32.57
PANEL WIDTH: 36"																																																				
75°																																																				
2"	14.95																																																			
2½"	20.00																																																			
3"	25.00																																																			
4"	32.57																																																			
PANEL WIDTH: 36"																																																				
75°																																																				
2"	14.95																																																			
2½"	20.00																																																			
3"	25.00																																																			
4"	32.57																																																			
PANEL WIDTH: 36"																																																				
75°																																																				
2"	14.95																																																			
2½"	20.00																																																			
3"	25.00																																																			
4"	32.57																																																			
PANEL WIDTH: 36"																																																				
75°																																																				
2"	14.95																																																			
2½"	20.00																																																			
3"	25.00																																																			
4"	32.57																																																			

**NOTES:**

Based on a K-Factor of 0.14 at 75°F core mean temperature.

U-Factors and R-Values include air film.

R-Values are inverse of U-Factors. Not core R-Value.

## PROFILED WALL PANELS POLYURETHANE CORE



7.2 INSUL RIB



MESA & LIGHT MESA



FLUTED



STRIATED



PARTITION



36"

2½", 3", 4", 5", 6"

8'-0" to 40'-0"

PANEL WIDTH: 36"

75"	
2½"	0.1114
3"	0.0814
4"	0.0537
5"	0.0395
6"	0.0314

PANEL WIDTH: 36"

75"	
2½"	8.98
3"	12.29
4"	18.62
5"	25.32
6"	31.85

36", 42"

MESA 2", 2½", 3", 4", 5", 6"  
LIGHT MESA 2", 2½", 3", 4"  
2¾" available from Nevada plant

8'-0" to 53'-0"

PANEL WIDTH: 42"

75"	
2"	0.0706
2½"	0.0516
3"	0.0424
4"	0.0324
5"	0.0264
6"	0.0224

PANEL WIDTH: 42"

75"	
2"	14.16
2½"	19.38
3"	23.58
4"	30.86
5"	37.88
6"	44.64

42"

2", 2½", 3", 4", 5", 6"  
2¾" available from Nevada plant

8'-0" to 53'-0"

PANEL WIDTH: 42"

75"	
2"	0.0721
2½"	0.0523
3"	0.0432
4"	0.0328
5"	0.0267
6"	0.0226

PANEL WIDTH: 42"

75"	
2"	13.87
2½"	19.12
3"	23.15
4"	30.49
5"	37.45
6"	44.25

30", 36", 42"

2", 2½", 3", 4"  
2¾" available from Nevada plant

30", 36" WIDTHS: 8'-0" to 40'-0"  
42" WIDTH: 8'-0" to 32'-0"

PANEL WIDTH: 42"

75"	
2"	0.0706
2½"	0.0516
3"	0.0424
4"	0.0324

PANEL WIDTH: 42"

75"	
2"	14.16
2½"	19.38
3"	23.58
4"	30.86

44½"

2", 2½", 3", 4", 5", 6"  
2¾" available from Nevada plant

8'-0" to 53'-0"

PANEL WIDTH: 44½"

75"	
2"	0.0706
2½"	0.0516
3"	0.0424
4"	0.0324
5"	0.0264
6"	0.0224

PANEL WIDTH: 44½"

75"	
2"	14.16
2½"	19.38
3"	23.58
4"	30.86
5"	37.88
6"	44.64

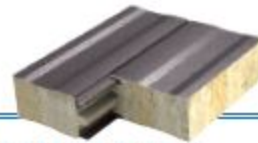

## SPECIALIZED PANELS POLYURETHANE CORE



HPCI BARRIER

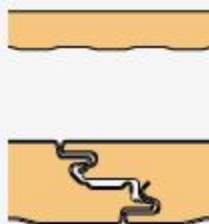

42"

2", 3", 4"

8'-0" to 24'-0"

PANEL WIDTH: 42"

	75"
2"	0.0706
3"	0.0424
4"	0.0324

PANEL WIDTH: 42"

	75"
2"	14.16
3"	23.58
4"	30.86



CFR INSULATED  
METAL ROOF

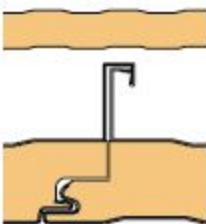

30", 36", 42"

2", 2½", 3", 4", 5", 6"

9'-6" to 53'-0"

PANEL WIDTH: 42"

	75"
2"	0.0600
2½"	0.0490
3"	0.0414
4"	0.0318
5"	0.0257
6"	0.0217

PANEL WIDTH: 42"

	75"
2"	16.67
2½"	20.41
3"	24.15
4"	31.45
5"	38.91
6"	46.08

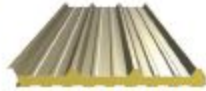

LS-36™ INSULATED  
METAL ROOF & WALL  
EXPOSED FASTENERS



36"

1½", 2", 2 ½", 3", 4", 5", 6"

8'-0" to 50'-0"

PANEL WIDTH: 36"

	75"
1½"	0.0788
2"	0.0603
2½"	0.0492
3"	0.0416
4"	0.0327
5"	0.0267
6"	0.0223

PANEL WIDTH: 36"

	75"
1½"	12.69
2"	16.98
2½"	20.33
3"	24.04
4"	30.98
5"	37.45
6"	44.84

## FIRE RESISTANT PANELS MINERAL WOOL CORE



THERMSAFE®  
MINERAL WOOL

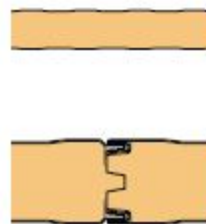

42"

Nominal 4", 5", 6", 7", 8"

Non-combustible, rigid mineral wool lamellae. Mineral wool fibers are oriented perpendicular to the panel faces for maximum structural strength.

8'-0" to 40'-0"

Variable by thickness

PANEL WIDTH: 42"

	75"
4"	0.0654
5"	0.0529
6"	0.0444
7"	0.0383
8"	0.0336

PANEL WIDTH: 42"

	75"
4"	15.29
5"	18.90
6"	22.51
7"	26.12
8"	29.73



THERMSAFE® NC  
(NON-COMBUSTIBLE)

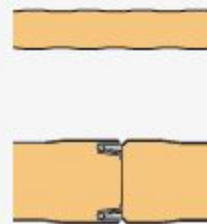

42"

Nominal 3"

Non-combustible, rigid mineral wool lamellae. Mineral wool fibers are oriented perpendicular to the panel faces for maximum structural strength.

8'-0" to 40'-0"

PANEL WIDTH: 42"

	75"
3"	0.0856

PANEL WIDTH: 42"

	75"
3"	11.68

# Envelope Solutions

---



## METL-VISION® WINDOW SYSTEM

Engineered to integrate fully with INNOVA™ 2' and 3' horizontal wall panels, the Metl-Vision flush frame eliminates interface problems commonly encountered with standard windows, and sight lines are minimized to enhance finished assembly appearance.

### WINDOW HEIGHT

Available in increments matching standard wall panel widths of 24", 30" and 36". Custom widths and corresponding heights are available between 24" and 36". Maximum is 20'.

### WINDOW WIDTH

Virtually unlimited widths are obtainable using spliced head and sill members in combination with intermediate vertical muntins. Window unit jambs can be located to match with vertical wall panel joints or located away.

### GLAZING MATERIAL THICKNESS

Standard 1"

### WINDOW PROJECTION

The frame is 4" deep and designed to fit flush with exterior panels.

### LITE OPENING

6' maximum

### FINISHES

ANODIZED: clear, dark bronze, black  
2-COAT PAINTED: custom color consisting of fluoropolymer coatings  
3-COAT PAINTED: custom color consisting of fluoropolymer coatings and clear coat  
MILL FINISH: bare aluminum



## ARCHITECTURAL SUNSHADES

Vertical Sunshades, Airfoil & Screen Wall Sunshades, Eggcrate Grille Sunshades and Radiused Sunshade.



## ARCHITECTURAL LIGHT SHELVES

Light shelves reflect sunlight up to the ceiling, distributing it more evenly to make surfaces feel bigger and brighter.



## ARCHITECTURAL GRILLES

Grilles and screenwalls provide striking visual impact to building facades and shield unattractive equipment or construction from view, all in one energy-efficient package.



## COLUMN COVERS AND BEAM WRAPS

Column Covers, Square Column Covers, Specialty Shape Column Wraps, and Beam Wraps.



## LOUVERS

Drainable and storm-resistant architectural louvers are designed to complement building envelope systems and are available in a wide array of customizable options.

[metlspan.com](http://metlspan.com)



As a pioneer in insulated metal panel development for over 45 years, we continue to make significant contributions to many product design innovations and technology improvements that shape industry standards. We are constantly expanding our research and process capabilities in order to provide the highest quality products possible.

1720 Lakepointe Drive  
Suite #101  
Lewisville, Texas 75057  
TOLL-FREE 877.585.9969  
TEL 972.221.6656  
FAX 972.420.9382

© 2015 Metl-Span - A Division of NCI Group, Inc. - All rights reserved. Printed in the U.S.A. METL-15-004-REV

