

COMMERCIAL AND SELF-STORAGE

DOORS

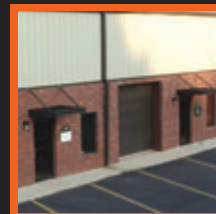

Integrity. Partnership. Quality.

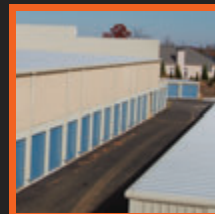

Since 1990, DBCI continues in its role as a leading manufacturer and marketer of commercial-grade steel curtain roll-up doors for both the commercial and self-storage markets. We provide our customers with quality products, distinguished service and competitive pricing.

DBCI employs the most skilled sales professionals and production personnel in the industry to ensure ready access to the support you need. With sales representatives located throughout the United States, we're available to meet your needs at any time in any place.

Why Choose DBCI?

The backbone of the DBCI product line is its roll-up door. We were one of the first manufacturers to dedicate resources to a commercial door product category, and today we remain an influential leader in the industry. Utilizing an in-house wind-testing facility and state-of-the-art manufacturing equipment enables DBCI to manufacture its doors to the highest standards.

DBCI remains true to its commitment of partnership, innovation and the manufacturing of superior products through numerous techniques. We offer solutions that best accommodate our customers and add value to your business.

DBCI is committed to helping you get the most from your products. We offer accurate, timely estimates before the sale and responsive service after the sale.

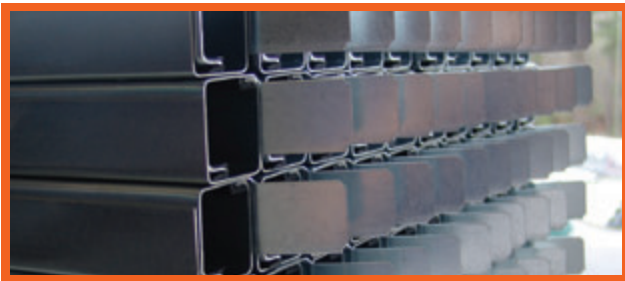

CURTAIN

Commercial and Self-Storage Doors

DBCI's steel curtain roll-up doors are manufactured with hard, Grade E steel, ensuring strength and durability. We offer 15 standard colors and 7 non-standard colors. Please see our color chart, attainable on our website or by contacting your local DBCI sales representative, for color options.

SPRINGS

Commercial and Self-Storage Doors

Springs are the most critical mechanical component of a steel curtain roll-up door. For maximum reliability, DBCI uses only oil-tempered torsion-type springs for its doors. Coordinating the design of a roll-up door with the proper spring assembly ensures longer and more durable use with minimal maintenance.

COMMERCIAL DOORS

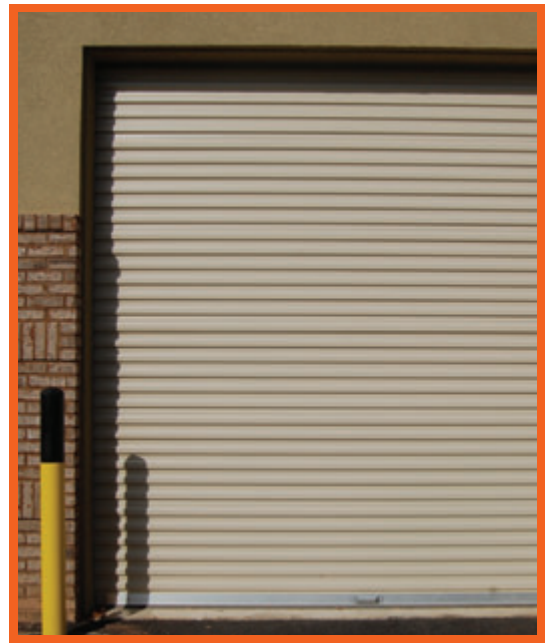

DBCI's commercial doors are designed and manufactured for strength and durability. They consist of interlaced steel sections forming a continuous corrugated profile. DBCI's commercial doors are fabricated to meet or exceed operational requirements with little or no maintenance. Whether you are a contractor, architect, supplier, door dealer or business owner, we have commercial roll-up doors to satisfy your needs.

Commercial Door Features

Vision Panel

Constructed of translucent flexible polycarbonate, the 5" x 17" vision panel allows light entry and provides outside visibility. The white 20-gauge frame is pop-riveted and is normally installed approximately 55" from the floor. The location and number of panels per door is limited.

A.C.E. Guide Systems

The A.C.E. (Advanced Curtain Engagement) guide system has been designed for DBCI's customers. Some of the benefits include universal mounting options, increased durability, excellent performance and ease of installation.

Axle-Drum Assembly

DBCI's commercial door axles and drums are manufactured with industrial-grade steel. The door drums are designed and engineered specifically for commercial applications to ensure product integrity, a long life and high-capacity use.



Curtain

- 26-gauge galvanized, Grade E hard steel
- Deep-ribbed corrugation
- Maximum opening size of 12' x 18'
- Flexible wear strips



Bottom Bar

- 6063 – T6 aluminum extrusion
- 2" x 1 1/2" galvanized angles
- Bulb astragal
- Stainless steel nuts and bolts



Axle-Drum Assembly

- 1 5/16" O.D. steel axle, 14-gauge
- 11-gauge axle on doors over 10' wide
- Utilizes 12", 16-gauge drums
- Shielded steel ball bearings in drums
- Full top sheet



A.C.E. Guide System

- 16-gauge galvanized steel
- Adjustable bolt on head stop
- Polyethylene wear strip
- Pre-punched for lock and attachment fasteners

Hardware

- Saddle clamps with set fasteners
- 10-gauge slide locks; 2 per door
- 16-gauge step plate; 2 per door
- 1/4" steel angle T-bracket

Opening Height Headroom

- Doors up to 10' have 20" of headroom
- Doors 10' to 14' have 22" of headroom
- Doors over 14' have 24" of headroom

Options

- Insulated 2250 Series
- 1900 Series – low overhead option
- Chain hoist 4:1 reduction
- Vision panels (17" x 5")
- Top draft stop
- Hood
- Steel mounting plates
- Electric operator

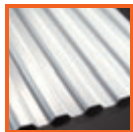
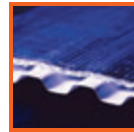
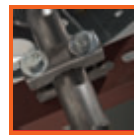

Curtain

- 26-gauge galvanized, Grade E hard steel
- Deep-ribbed corrugation
- Maximum opening size of 18' x 18'
- Flexible wear strips

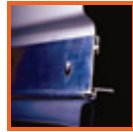

Bottom Bar

- 6063 – T6 aluminum extrusion
- 2" x 1 1/2" galvanized angles
- Bulb astragal
- Stainless steel nuts and bolts



Axle-Drum Assembly

- 1 5/16" O.D. steel axle, 14-gauge
- 11-gauge axle on doors over 10' wide
- Utilizes 12", 16-gauge drums
- Shielded steel ball bearings in drums
- Full top sheet
- Oil tempered torsion springs



A.C.E. Guide System

- 14-gauge galvanized steel
- Adjustable bolt on head stop
- Polyethylene wear strip
- Pre-punched for lock and attachment fasteners

Hardware

- Saddle clamps with set fasteners
- 10-gauge slide locks; 2 per door
- 16-gauge step plate; 2 per door
- 1/4" steel welded angle T-bracket

Opening Height Headroom

- Doors up to 10' have 20" of headroom
- Doors 10' to 14' have 22" of headroom
- Doors over 14' have 24" of headroom

Options

- Insulated 2750 Series
- Chain hoist 4:1 reduction
- Vision panels (17" x 5")
- Top draft stop
- Hood
- Steel mounting plates
- Electric operator
- Low headroom 2400 Series

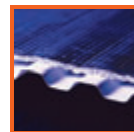

* ALL DETAILS APPLY TO 2000 AND 2500 SERIES

INTERIOR ELEVATION

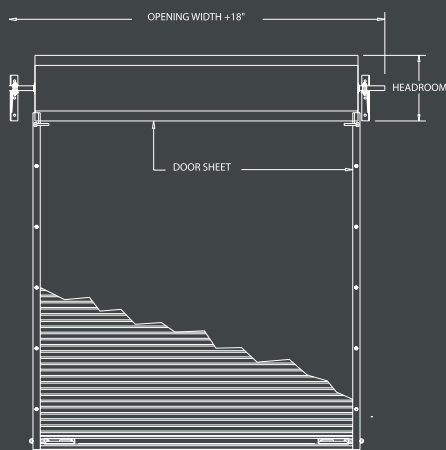

GUIDE MOUNTING SERIES 2000

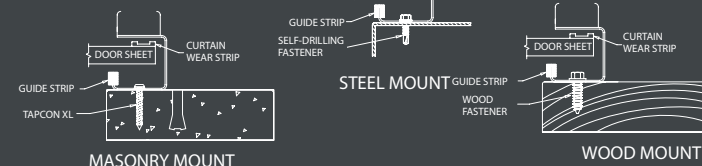

GUIDE MOUNTING SERIES 2500

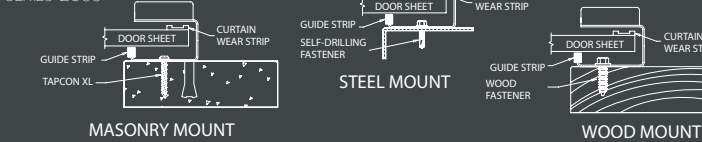

DOOR ENGAGEMENT SERIES 2000 AND 2500

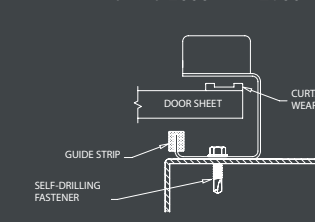

INSULATED DOOR DETAIL SERIES 2250 AND 2750

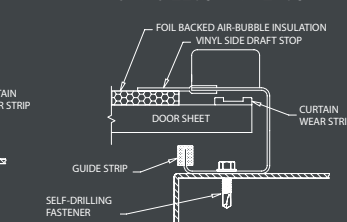

GUIDE DETAIL SERIES 2000

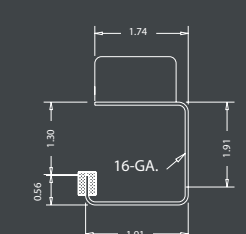

GUIDE DETAIL SERIES 2500

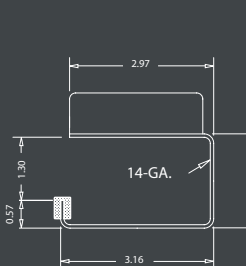

5000 SERIES

Fueled by constant changes in local and national building codes, as well as increasing insurance costs, doors with validated wind certification can dramatically reduce maintenance and replacement costs and minimize downtime. DBCI's wind-certified doors are designed to meet stringent building codes in coastal regions and Florida.



Curtain

- 26-gauge galvanized, Grade E hard steel
- Deep-ribbed corrugation with three-rivet windlock attachment
- Maximum opening sizes of 16' x 20' and 20' x 16'
- Flexible wear strips



Approximate* MPH Certification

- 10' wide = 150 mph
- 12' wide = 150 mph
- 14' wide = 146 mph
- 16' wide = 140 mph

*For test results on doors up to 20' wide, please contact DBCI Commercial Sales at 800.542.0501.



Bottom Bar

- 6063 - T6 aluminum extrusion
- 2" x 1 1/2" galvanized angles
- Bulb astragal
- Stainless steel nuts and bolts

Axle-Drum Assembly

- 1 5/16" O.D. steel axle, 14-gauge
- 11-gauge axle on doors over 10' wide
- Utilizes 12", 16-gauge drums
- Shielded steel ball bearings in drums
- Full top sheet
- Oil tempered torsion springs

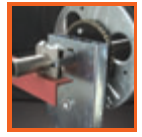

A.C.E. Guide System

- 12-gauge galvanized steel
- 12-gauge wind lock bar
- Adjustable bolt on head stop
- Polyethylene wear strip
- Pre-punched for lock and attachment fasteners



Hardware

- Saddle clamps with set fasteners
- 10-gauge slide locks; 2 per door
- 16-gauge step plate; 2 per door
- 1/4" steel angle T-bracket



Opening Height Headroom

- Doors up to 10' have 20" of headroom
- Doors 10' to 14' have 22" of headroom
- Doors over 14' have 24" of headroom



Options

- Insulated 5250 Series
- Chain hoist 8:1 reduction
- Header seal
- Hood
- Steel mounting plates
- Electric operator

* ALL DETAILS APPLY TO 5000 SERIES

INTERIOR ELEVATION

BRACKET ATTACHMENT:
CONCRETE/MASONRY: SLEEVE ANCHOR, 3/8" x 1-7/8" LG.
WOOD: LAG SCREW, 3/8"-7 x 3" LG.
STEEL: HEX BOLT, GR.5, 3/8-24 x 1-1/4" LG.

(*) FOR PUSH-UP OPERATION 6-1/2" FOR HAND CHAIN OR ELECTRIC OPERATION 10"
NOTE: LEFT SIDE DRIVE SHOWN

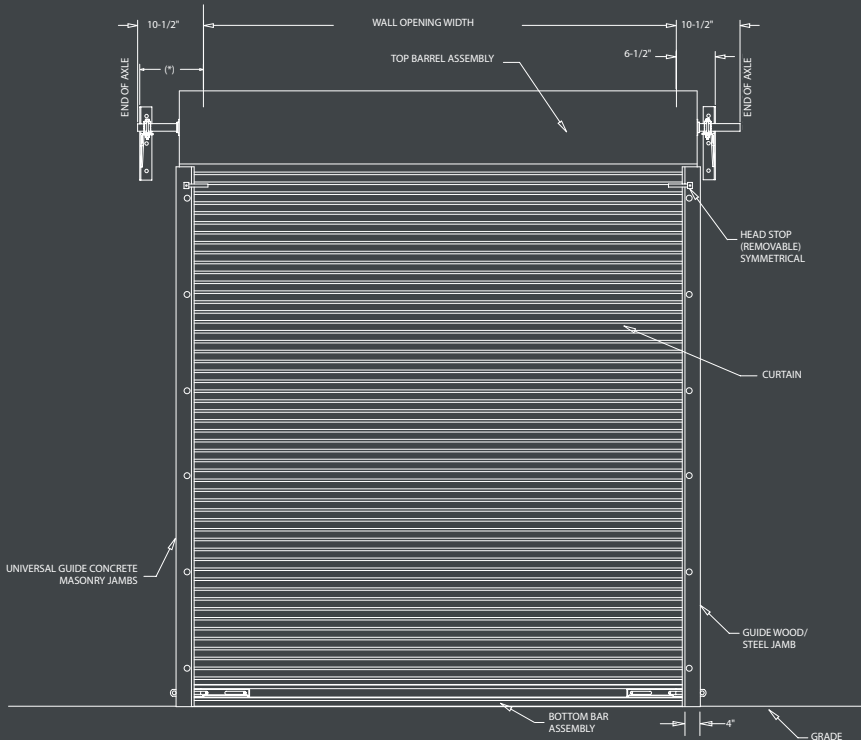

DOOR ENGAGEMENT

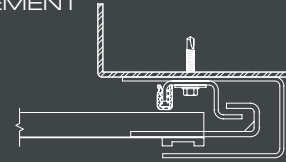

GUIDE DETAIL

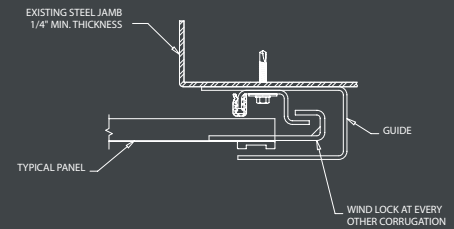

GUIDE MOUNTING

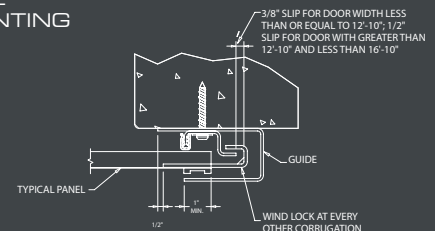

MASONRY MOUNT

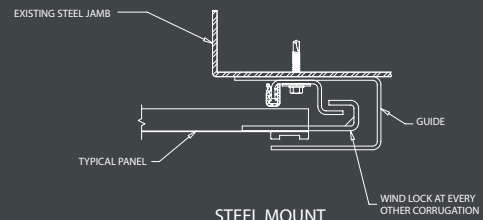

STEEL MOUNT



DBCI's self-storage doors and solutions are fabricated to meet the demands of the industry. They provide quick-and-easy installation, minimal maintenance, superior strength and exceptional durability.

SELF-STORAGE DOOR FEATURES

Bottom Bar

The purpose of the bottom bar is to add strength and security to the door. This functional bar has a clean, attractive finish that enhances the appearance of the doors. DBCI's bottom bars are constructed of 6063 – T6 aluminum, which looks and wears well. Our vinyl weather seal is replaceable, which means that damage, wear and weather do not necessarily require replacement of the entire self-storage door.

Tension Set Brackets

Tension set brackets control how easily the self-storage doors open when unlocked. Older self-storage doors lack tension adjusters and require a door technician to readjust the spring tension. Our tension set brackets make adjusting roll-up doors easier, safer and faster. Facility maintenance personnel can adjust the self-storage doors themselves in as little as five minutes.

Latches

Latches keep the doors closed and the storage unit's contents safe. DBCI's stainless steel and Apex latches maintain their integrity through the years. Our latches are constructed with limited pry points, double padlock compatibility and the ability to operate with magnetic alarm systems.



SELF-STORAGE DOORS



650 SERIES



Curtain

- 26-gauge galvanized, Grade E hard steel
- $\frac{5}{8}$ " ribbed corrugation
- Many latch options available
- All latches accept double locks and $\frac{7}{16}$ " shackles
- **Rain lip note:** For proper exterior door installation, a 1 $\frac{1}{2}$ " deep rain lip must be formed in the concrete slab extending a minimum of 3 $\frac{1}{2}$ " from the interior face of the jamb

Bottom Bar

- 6063 – T6 aluminum extrusion
- 1 $\frac{1}{2}$ " x 1 $\frac{1}{2}$ " galvanized angles
- Replaceable bulb astragal

Axle-Drum Assembly

- 1 $\frac{5}{16}$ " O.D. steel axle, 14-gauge
- Utilizes 9 $\frac{1}{2}$ ", 18-gauge drums
- Oil tempered e-coated torsion springs, available in two springs upon request from 7' to 10' wide
- Fully accessible springs for inspection and maintenance

Guide System

- 18-gauge galvanized steel
- Pre-punched holes for anchors, slide latch, bracket attachment and head stop attachment
- Polyethylene guide strips provide easy, quiet operation

Hardware

- 12-gauge head stops have slotted mounting holes for proper attachment
- 14-gauge galvanized steel handles
- 12-gauge tension bracket made for additional strength
- Shielded radial bearings for smooth operation
- Worm gear tensioning design allows for smooth adjustment
- 12-gauge bearing bracket on right side



Options

- Insulated 651 Series
- Top and side draft stop

690 SERIES

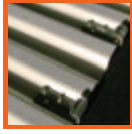

Curtain

- 26-gauge galvanized, Grade E hard steel
- $\frac{5}{8}$ " ribbed corrugation
- Many latch options available
- All latches accept double locks and $\frac{7}{16}$ " shackles
- **Rain lip note:** For proper exterior door installation, a 1 $\frac{1}{2}$ " deep rain lip must be formed in the concrete slab extending a minimum of 3 $\frac{1}{2}$ " from the interior face of the jamb

Bottom Bar

- 6063 – T6 aluminum extrusion
- 1 $\frac{1}{2}$ " x 1 $\frac{1}{2}$ " galvanized angles
- Replaceable bulb astragal

Axle-Drum Assembly

- 1 $\frac{5}{16}$ " O.D. steel axle, 14-gauge
- Utilizes 9 $\frac{1}{2}$ ", 18-gauge drums
- Oil tempered e-coated torsion springs, available in two springs upon request from 7' to 10' wide
- Fully accessible springs for inspection and maintenance

Guide System

- 16-gauge galvanized steel guides and wind bar
- Pre-punched holes for anchors, slide latch, bracket attachment and head stop attachment
- Polyethylene guide strips provide easy, quiet operation

Hardware

- 12-gauge head stops have slotted mounting holes for proper attachment
- 14-gauge galvanized steel handles
- 12-gauge tension bracket made for additional strength
- Shielded radial bearings for smooth operation
- Worm gear tensioning design allows for smooth adjustment
- 12-gauge bearing bracket on right side



Options

- Insulated 651 Series
- Top and side draft stop

* APPLIES TO 650 AND 690 SERIES

INTERIOR ELEVATION

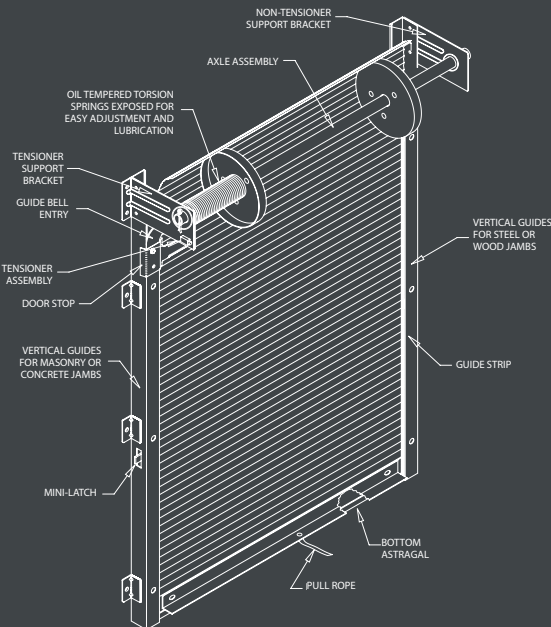

* APPLIES TO 650 SERIES

GUIDE DETAIL

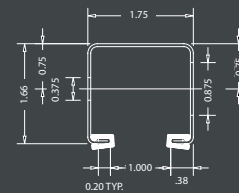

GUIDE MOUNTING

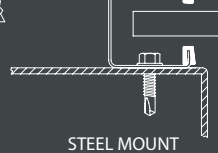

DOOR ENGAGEMENT

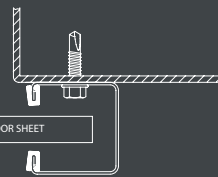

INSULATED DOOR DETAIL SERIES 651

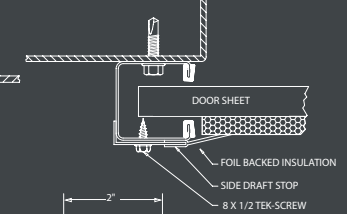

* APPLIES TO 690 SERIES

GUIDE MOUNTING

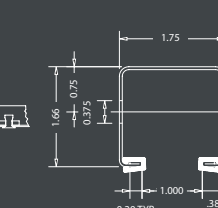
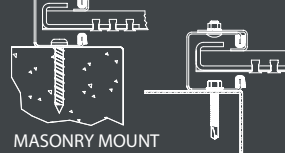

DOOR ENGAGEMENT



WINDBAR





Corrugated Swing Door

- 26-gauge door
- 20-gauge roll-formed X-bracing Galvalume® with rolled edges for added strength
- 20-gauge hemmed stiles
- Stainless steel or Apex latch for security
- Pre-punched for latch
- Two 90-degree zinc hinges
- Frame and one Securawall hall partition fills a 5'-wide unit
- ADA Compliant



Flush Swing Door

- 20-gauge flat sheet for door face
- Hat style stiffeners
- Glossy white frame
- Colors to match or complement your roll-up doors
- Seamless to complete a total flush hallway system
- Many latch options available
- 90-degree zinc hinges
- May be ordered with optional louvers to allow for air circulation
- ADA Compliant



Locker Units

- For smaller 5' x 5' units in both double and triple stack configurations
- Pre-hung corrugated doors
- 1" locker floor in 20-gauge Galvalume® 6" planks
- 20-gauge Galvalume® support angles
- #8 x 1/2" self-drilling fasteners
- 500 Series frame



Corrugated Swing Door

- 26-gauge door
- 20-gauge roll-formed X-bracing Galvalume® with rolled edges for added strength
- 20-gauge hemmed stiles
- Stainless steel or Apex latch for security
- Pre-punched for latch
- Two 90-degree zinc hinges
- Frame and one Securawall hall partition fills a 5'-wide unit
- ADA Compliant



Locker Units

- For smaller 5' x 5' units in both double and triple stack configurations
- Pre-hung corrugated or flush swing doors
- 1" locker floor in 20-gauge Galvalume® 6" planks
- 20-gauge Galvalume® support angles
- #8 x 1/2" self-drilling fasteners
- 300 or 500 Series frame



300 SERIES SWING DOOR SELF-STORAGE DOOR

* APPLIES TO 300 SERIES

CORRUGATED SWING DOOR DETAIL

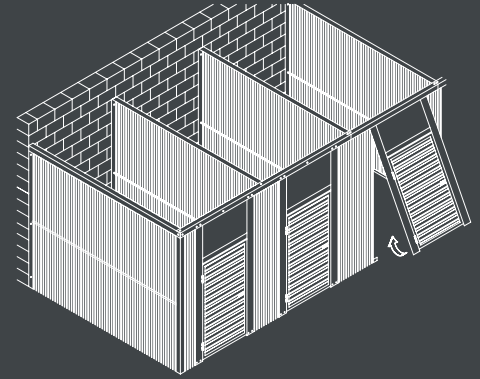

LOCKER FLOOR DETAIL

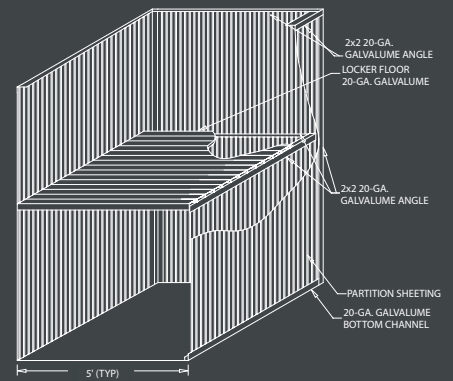

* APPLIES TO 500 SERIES

FLUSH DOOR DETAIL

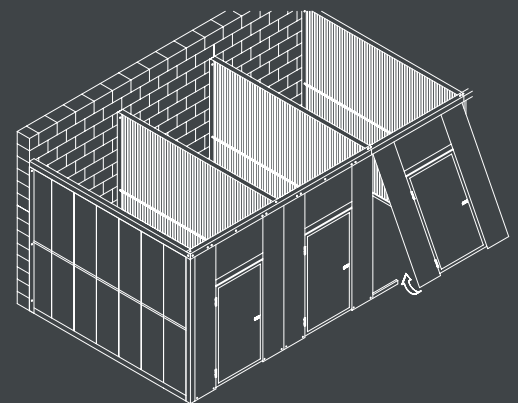

CORRUGATED DOOR DETAIL

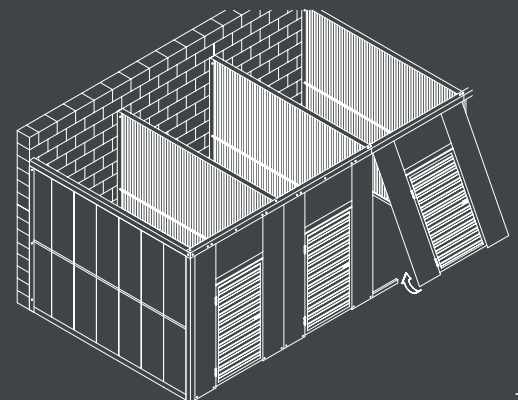

500 SERIES SWING DOOR SELF-STORAGE DOOR

SUMMIT SERIES

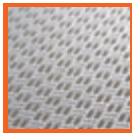

Flooring Component Options

- Mezzanine deck ¾" tongue-and-groove wood deck (gray or tan)
- Metal deck
- Concrete deck (supplied and poured by others)



Structural Load-Bearing Components

- 5' x 10' grid system
- Z-Purlins and C-Channel
- Structural PBU partition panels
- Corrugated metal decking
- Mezzanine stairs (optional)
- 125 psf floor-load rating



Optional Components

- Lifts
- Handrails
- Rolling Steel Doors (Slat Doors)
- Sectional Doors

Services

- Design of unit mix layout
- Structural drawings
- Installation of mezzanine components

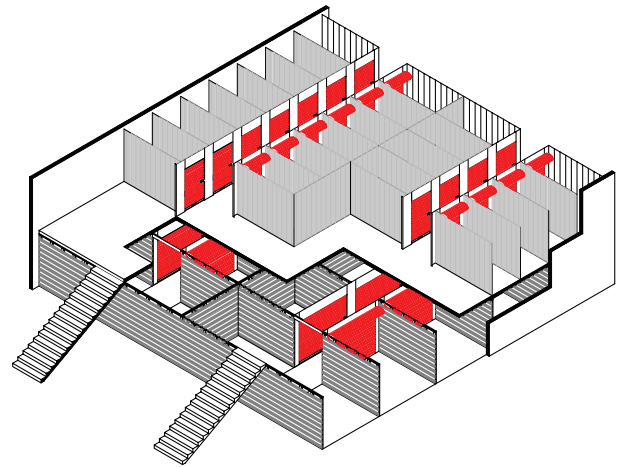

VINEYARD SERIES

The Vineyard series comes in multiple faux wood grain options and is made of galvanized steel. This product allows wine to mature without disturbance and provides protection against many damaging conditions. It also provides the classic look of wood without the expense.



Wine Locker Units

- Available in single- and double-stack configurations
- Available with pre-hung flush, vinyl-coated wood grain swing doors
- Complete 500 Series frame with vinyl wood grain coat
- 1" locker floor in 20-gauge Galvalume® 6" planks
- 20-gauge Galvalume® support angles
- #8 x ½" self-drilling fasteners

Flush Swing

- 20-gauge flat sheet for door face
- Hat style stiffeners
- Vinyl wood grain finish in variety of options
- Many latch options available
- 90-degree zinc hinges
- May be ordered with optional louvers to allow for air circulation



* ALL DETAILS APPLY TO VINEYARD SERIES

FLUSH DOOR
DETAIL

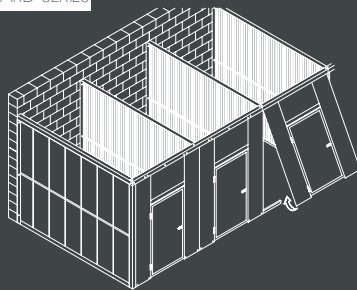

CORRUGATED
SWING DOOR
DETAIL

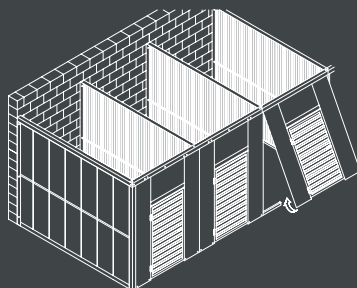

LOCKER
FLOOR
DETAIL

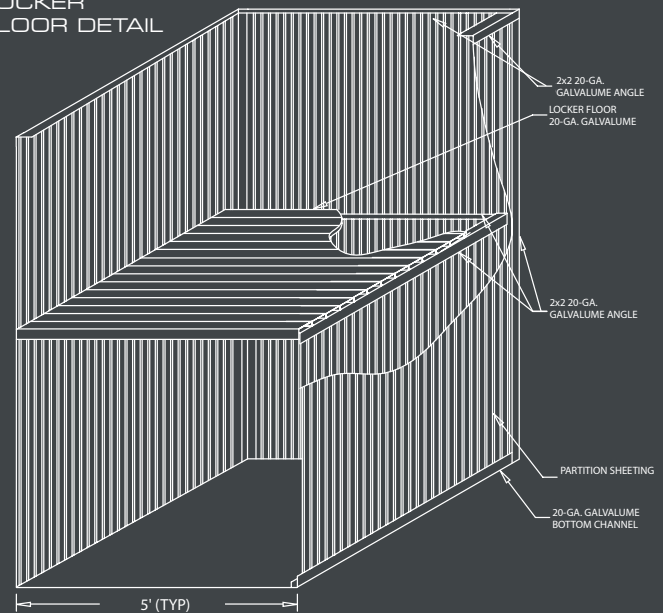



Roll-Up Frames

This strong, flush 20-gauge frame is used in both corrugated and flush hallway systems. The frames include base plates, back plates and top channels.

- 20-gauge back plate for mounting header/filler panel and roll-up door bracket
- 20-gauge base plate that mounts roll-up frame to door
- Press break construction for various sizes
- Available in glossy white or Galvalume®
- #8 x 1/2" glossy white self-drilling fasteners



Flush Header Panel

The flush header panel with roll-up frames creates a clean flush hallway. The glossy white flush header panel reflects light, providing a brighter interior.

- 20-gauge panel
- For interior hallway systems
- Single-piece construction
- Glossy white paint finish
- #8 x 1/2" glossy white self-drilling fasteners

Filler Panel

Filler panels are used in interior and exterior applications. The panels are available in matching or accenting colors.

- 26-gauge panel, support channel and angles
- Framed in at the sides, top and bottom with matching support channels
- Angles can be manufactured to match the color of the roll-up door or a contrasting color
- #8 x 1/2" self-drilling fasteners available



* ALL DETAILS APPLY TO FRAMES AND PANELS

**ROLL UP FRAME
DETAIL**

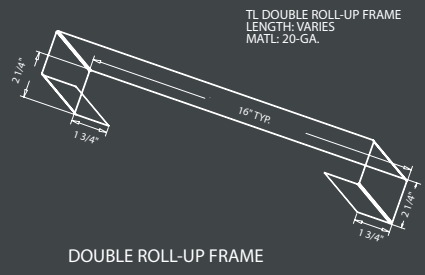
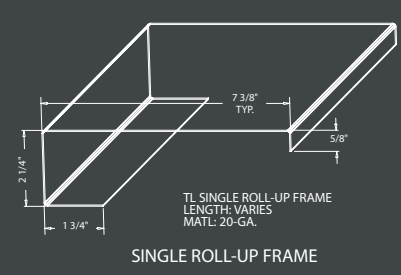

**FLUSH
HEADER
DETAIL**

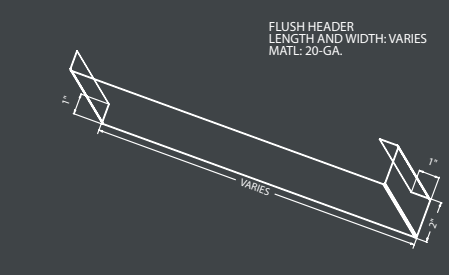

**FILLER PANEL
DETAIL**

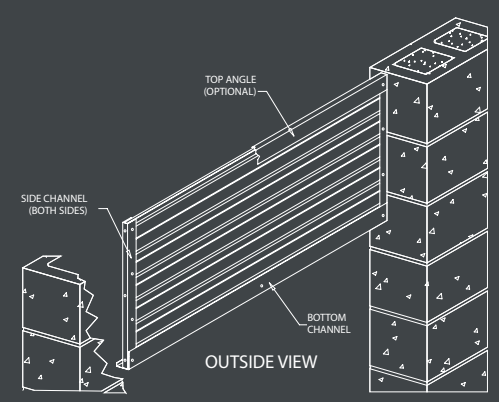

TRIM-LINE SYSTEM

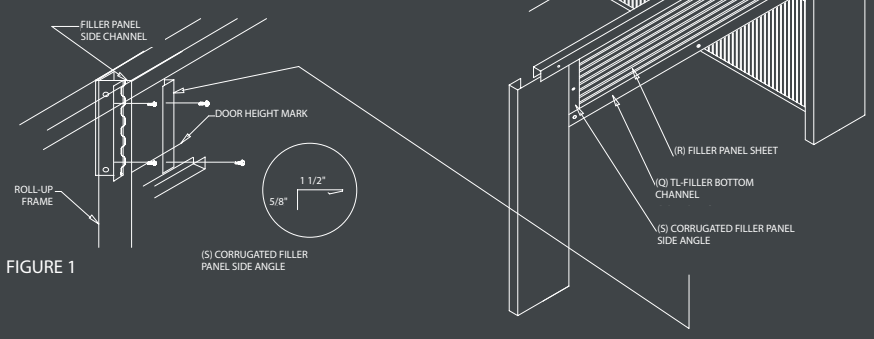

FIGURE 1

WALL SYSTEMS



Corawall Hallway System

This completely flush 24-gauge vertical interlocking hallway panel is available in glossy white or acrylic-coated Galvalume®. The 12" self-aligned interlocking panel allows for fasteners to remain concealed except where it is secured with a channel at the top.

- 24-gauge panel
- 20-gauge top channel
- 20-gauge bottom channel
- 22-gauge mid-span
- Interlocking flush design
- #8 x 1/2" glossy white self-drilling fasteners

Securawall Hallway System

The 20" wide, corrugated 26-gauge panels lock together tightly at the side seams without the use of exposed fasteners. The Securawall System provides an economical and attractive divider partition.

- 26-gauge panel
- 20-gauge top channel
- 20-gauge bottom channel
- 22-gauge mid-span
- Seam attachment design
- Available in glossy white and acrylic-coated Galvalume®
- #8 x 1/2" glossy white self-drilling fasteners

Securawall Unit Partition

The Securawall partition is a non-load bearing interior unit divider. It provides for an economical and attractive interior partition wall system. The 20"-wide sections lock together tightly at the side seams without the use of exposed fasteners.

- 26-gauge partition
- 20-gauge top angle
- 20-gauge bottom channel
- 22-gauge mid-span
- Seam attachment design
- Available in glossy white and acrylic-coated Galvalume®
- #8 x 1/2" glossy white self-drilling fasteners

Mid-Span

Mid-span horizontal bracing provides support for greater wall strength. Many customers use this inexpensive option to accommodate for unusual loads placed on walls by careless tenants.

- 20-gauge channel
- Utilizes a hem and channel construction to eliminate sharp edges and conceal exposed fasteners

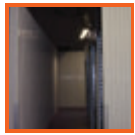

* ALL DETAILS APPLY TO WALL SYSTEMS

CORAWALL DETAIL

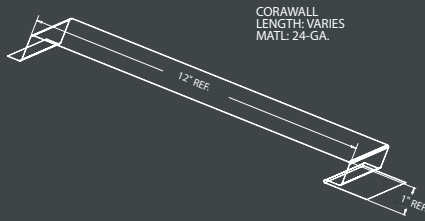

SECURAWALL UNIT PARTITION DETAIL

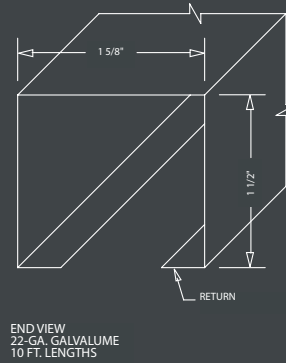

SECURAWALL HALLWAY PARTITION DETAIL

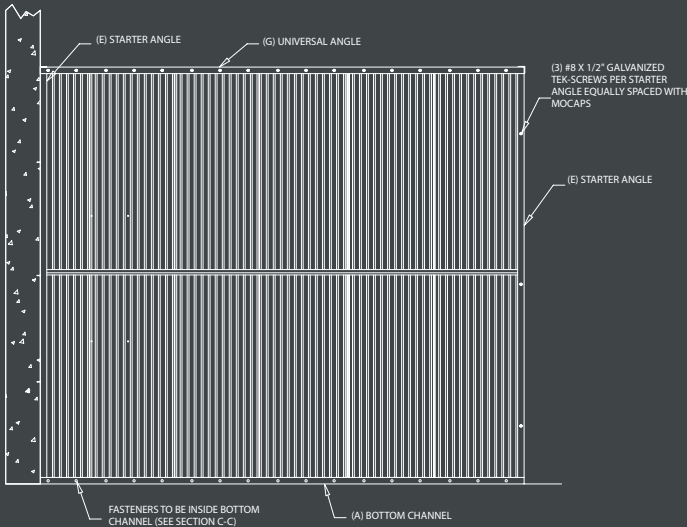

APPLICATION OF OPTIONAL MID SPAN BRACING

MID-SPAN DETAIL

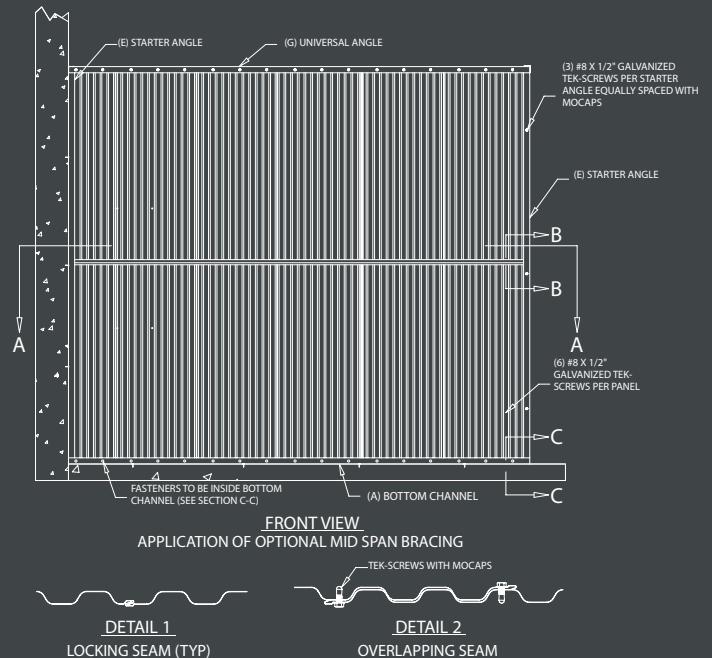

DETAIL 1
LOCKING SEAM (TYP)

DETAIL 2
OVERLAPPING SEAM

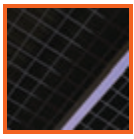

Mesh

Mesh can be installed either horizontally above or vertically between units. The galvanized mesh is attached to the top edges of the units by mesh angles. The mesh should be used in storage units with overhead gaps that might allow entry.

- 2" x 2" 16-gauge welded wire
- 2" x 2" Galvalume® mesh angles
- #8 x 1/2" self-drilling fasteners
- 26-gauge special wire mesh clips



Burglar Bars

The burglar bars are galvanized hat channels that provide security for the space above the top of the hallway system or above the unit partition. The burglar bar attaches horizontally to the existing support columns at 8" increments to provide additional security.

- 2 3/4"-wide galvanized channels
- Self-drilling fasteners
- Available in glossy white or acrylic-coated Galvalume®

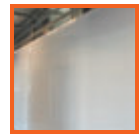

Kickplates

The 18-gauge Galvalume® strip provides excellent protection from pushcarts and hall traffic while giving a clean, cosmetic appearance.

- 18-gauge Galvalume® strip
- Pressure bend top and bottom
- #8 x 1/2" self-drilling fasteners
- Available in a galvanized or diamond plate tread design



Corner Guards

Optional corner guards provide long-lasting durability for both corrugated and flush hallway systems. The 18-gauge Galvalume® angle protects against damage from hall traffic while complementing the interior appearance.

- 18-gauge Galvalume® angle
- Pressure bends on leading edges
- Standard 4"-tall or full-hall height is available
- Mitered corners also available
- #8 x 1/2" self-drilling fasteners
- Available in a galvanized or diamond plate tread design



Mullions

Mullions are economical, non-structural, painted flush jambs that divide larger exterior units into smaller openings.

- 26-gauge painted mullion skin
- 20-gauge base plate
- 20-gauge extensions
- One pair 18-gauge mini-guides

Soffit Systems

Light Soffit. The light soffit is a 1' x 10' flush system that accommodates an optional 1' x 4' flush fluorescent light. When used with other DBCI hallway products, the soffit helps establish a bright and safe atmosphere for the owner and tenants.

Hallway Soffit. The three-piece, 26-gauge flush soffit complements the interior system with a bright, reflective hallway ceiling. The 3'-wide soffit leaves a 1' gap on both sides to allow for air circulation while concealing HVAC ducts, electrical, plumbing and sprinkler work. The hallway soffit can also be used to support hallway lighting.

Entry Soffit. Entry or full soffit is used in areas where HVAC, electrical, plumbing and sprinkler systems are completely concealed.

- 26-gauge
- 20-gauge universal soffit channel supports soffit panels
- Glossy white paint finish
- Specific soffit pieces nest together to create a flush soffit
- 1' x 4' GT static troffer light
- 2" x 2" glossy white angle
- #8 x 1/2" glossy white self-drilling fasteners

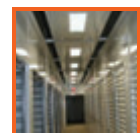
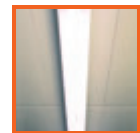
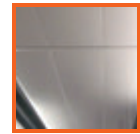

LIGHT SOFFIT DETAIL

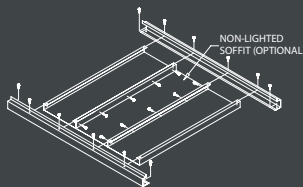

ENTRY SOFFIT

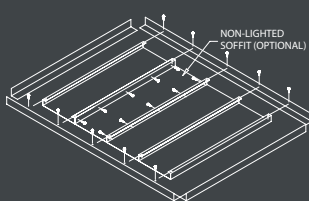

HALLWAY SOFFIT DETAIL

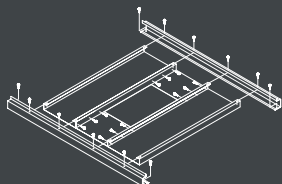

* APPLIES TO SECURITY

MESH DETAIL

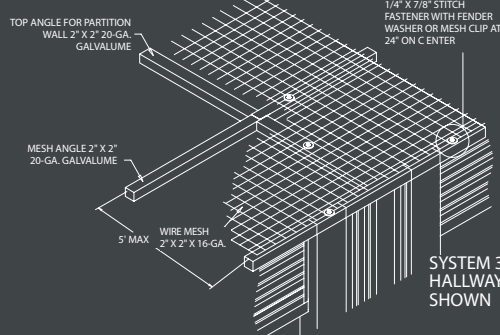

BURGLAR BAR DETAIL

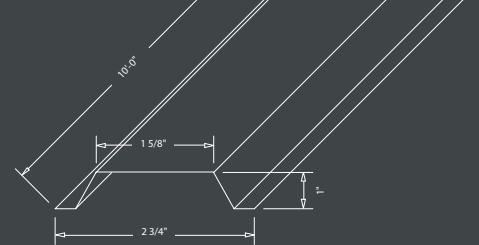

* APPLIES TO ACCESSORIES

KICKPLATE DETAIL

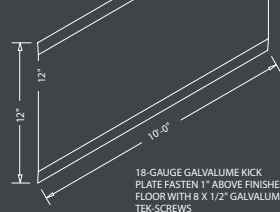

CORNER GUARD DETAIL

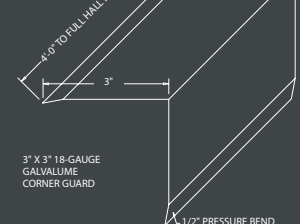



Toll Free: 800.542.0501 | E-mail: dbci.sales@dbci.com | Website: www.DBCI.com

DOUGLASVILLE, GA • HOUSTON, TX • CHANDLER, AZ