

RAKE AND RAKE SUPPORT ANGLES

PIECE MARKS

RAKE SUPPORT ANGLE PIECE MARKS

- LOW - HW7710 (SHOWN)
- HIGH - HW7720
- HIGH THERMAL - HW7664
- UTILITY - HW7722

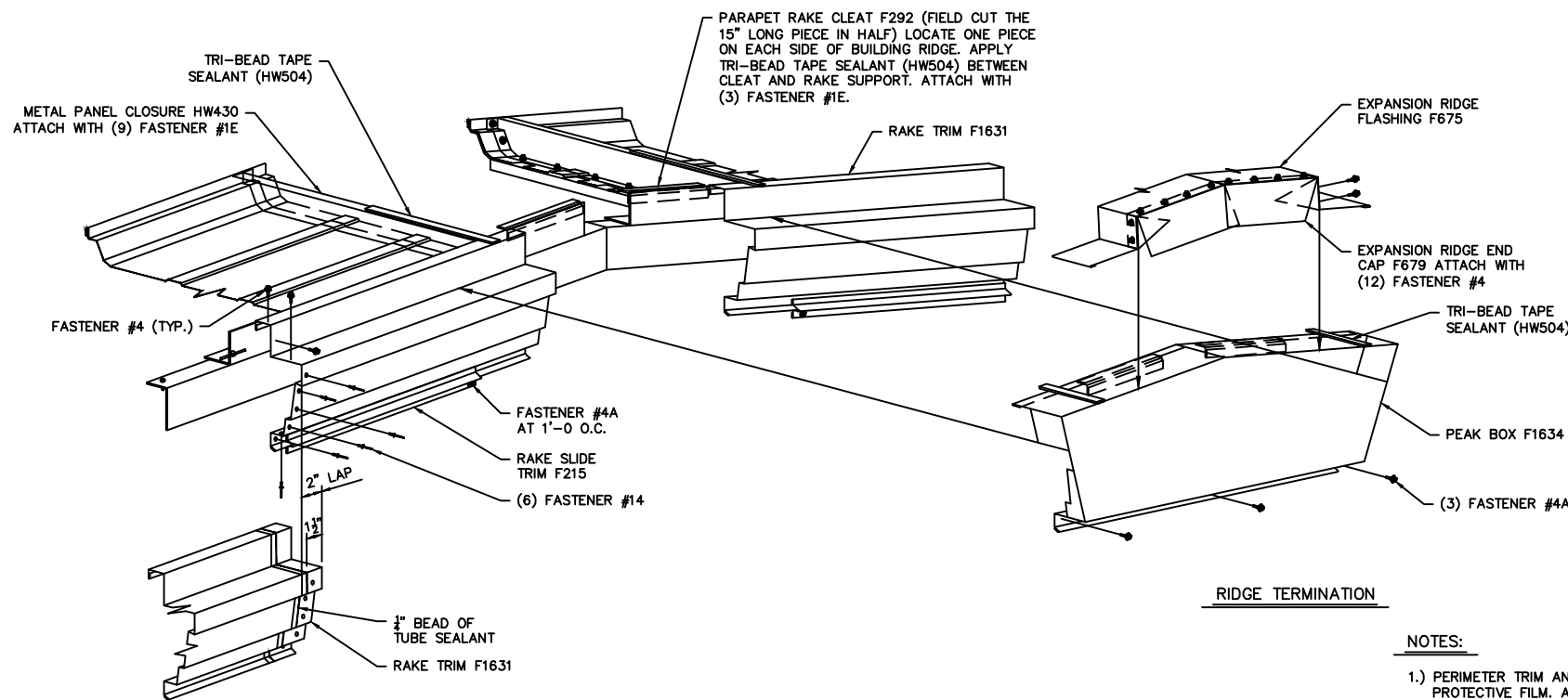

PEAK BOX ATTACHMENT

RIDGE TERMINATION

NOTES:

- 1.) PERIMETER TRIM AND GUTTERS MAY BE COATED WITH A REMOVABLE PROTECTIVE FILM. AFTER PROLONGED PERIODS OF EXPOSURE TO DIRECT SUNLIGHT THE FILM MAY BECOME BRITTLE AND DIFFICULT TO REMOVE.
- 2.) TO AVOID SUCH DIFFICULTIES, COVER THESE PARTS FROM DIRECT SUNLIGHT AT THE STORAGE SITE AND JOBSITE. REMOVE THE PROTECTIVE FILM DURING ERECTION OR IMMEDIATELY AFTER.
- 3.) TRIM PARTS ARE PROVIDED IN STANDARD LENGTHS AND MAY REQUIRE FIELD CUTTING TO LENGTH. (NOTE, THE REMAINDER MAY BE REQUIRED AT DIFFERENT LOCATION.)
- 4.) ROOF AND WALL PANELS SHOULD BE CLEANED OF ANY DRILL SHAVINGS OR FIELD CUTTING FILINGS AT THE END OF EACH DAY TO PREVENT RUSTING OF THESE PARTICLES.

RAKE TRIM LAP

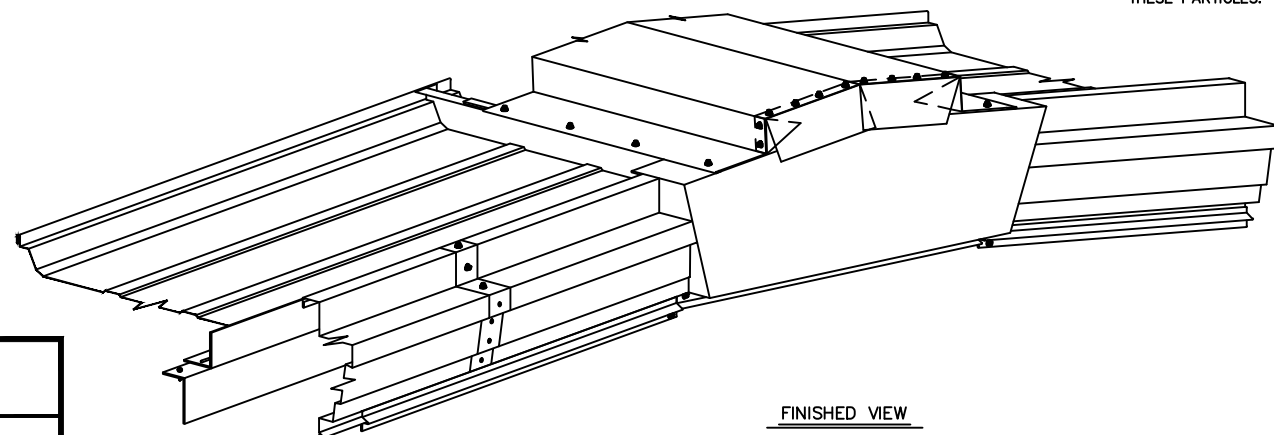

FINISHED VIEW

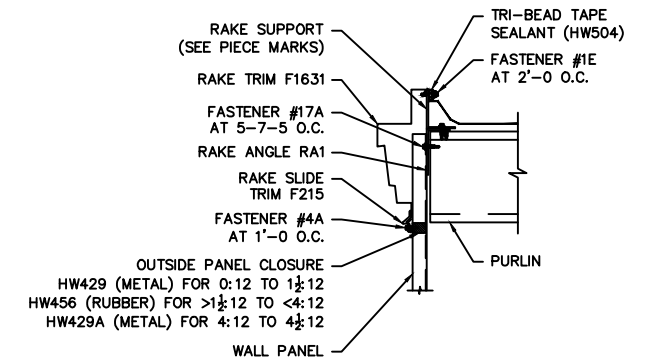

STANDARD SECTION AT PBR WALL

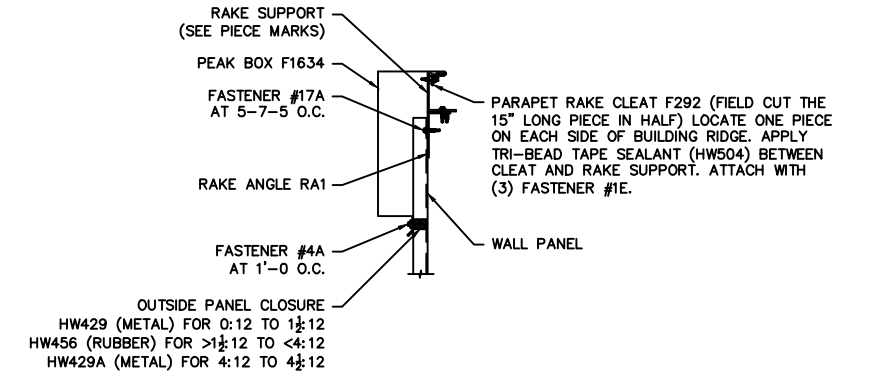

PEAK BOX SECTION AT PBR WALL

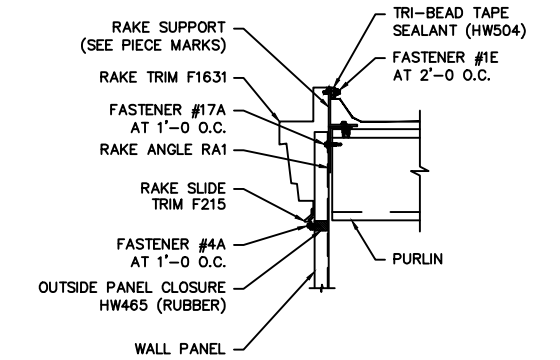

STANDARD SECTION AT AVP WALL

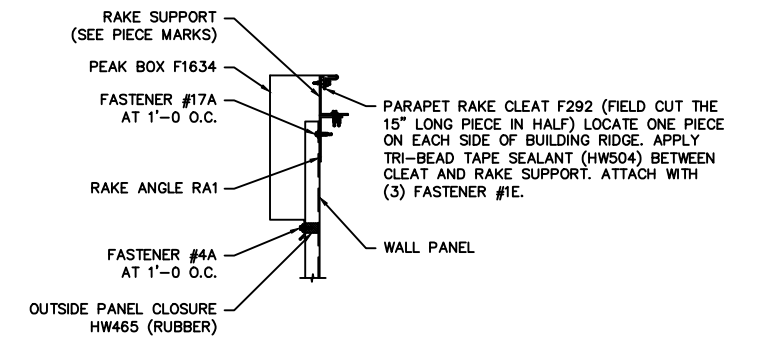

PEAK BOX SECTION AT AVP WALL