

Knock-In Bridging Installation Less Than 3:12 Single Row

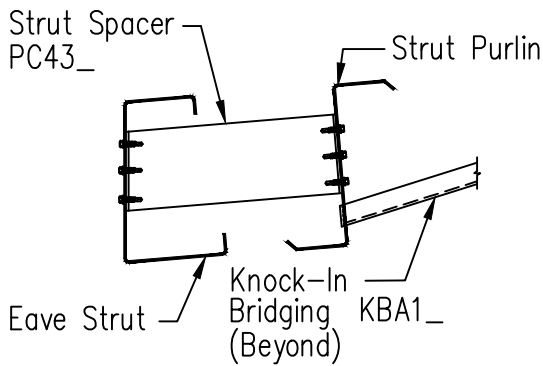

Strut Purlin At Eave

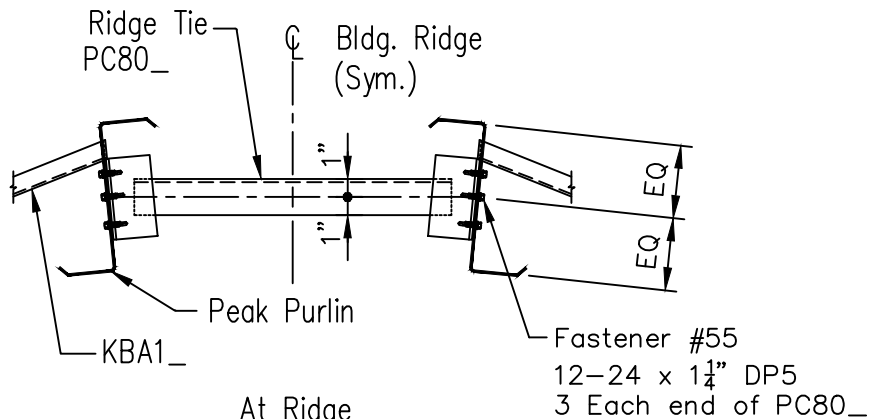

At Ridge

All fasteners shown are #1B
1/4"-14 x 1 1/4" DP3 unless noted

Note: The Bridging Angle will be installed from the top slot of the high side purlin to the bottom slot of the adjacent low side purlin.

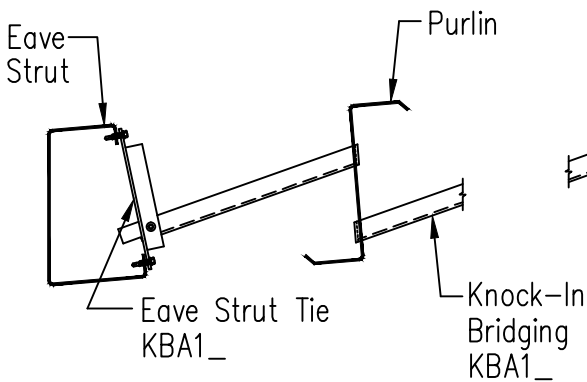

Low Side Eave Strut

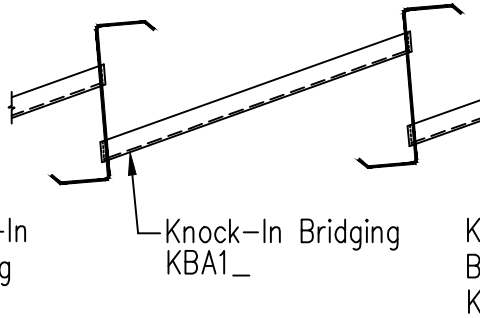

Purlin to Purlin

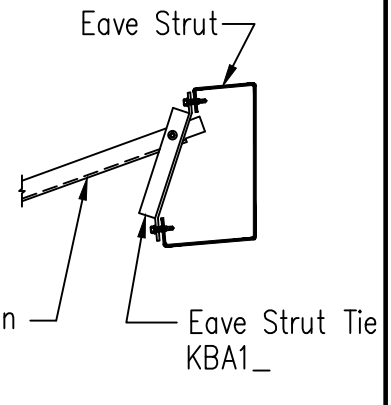

High Side Eave Strut

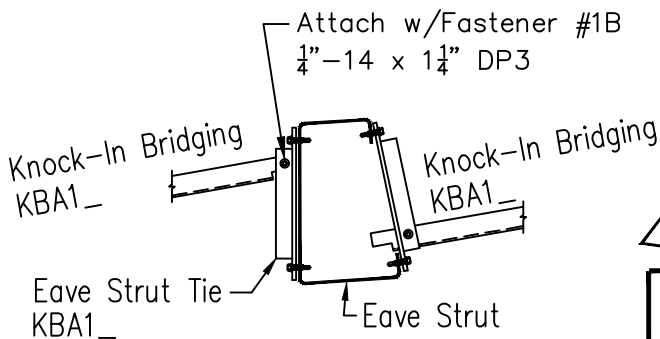

Continuous Roof
Low Side Shown, High Side Similar

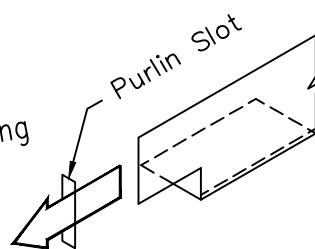

Step 1
Insert Tab Into Slot

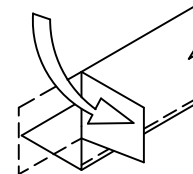

Step 2
Bend Tab 90 Degrees

Note: The bridging must be inserted into the pre-punched slot in the Purlin as shown in Step 1 and the tab bent side ways for proper installation Step 2. The process must be complete for the bridging to function as designed.