

Valley Connection - Purlin to Rafter Valley Clip Details with "Optional" Liner Flange Brace Connection

All bolts shown are $\frac{1}{2}"\phi$ A325.
Refer to $\frac{1}{2}"\phi$ A325 Bolt Grip
Table for required bolt length.

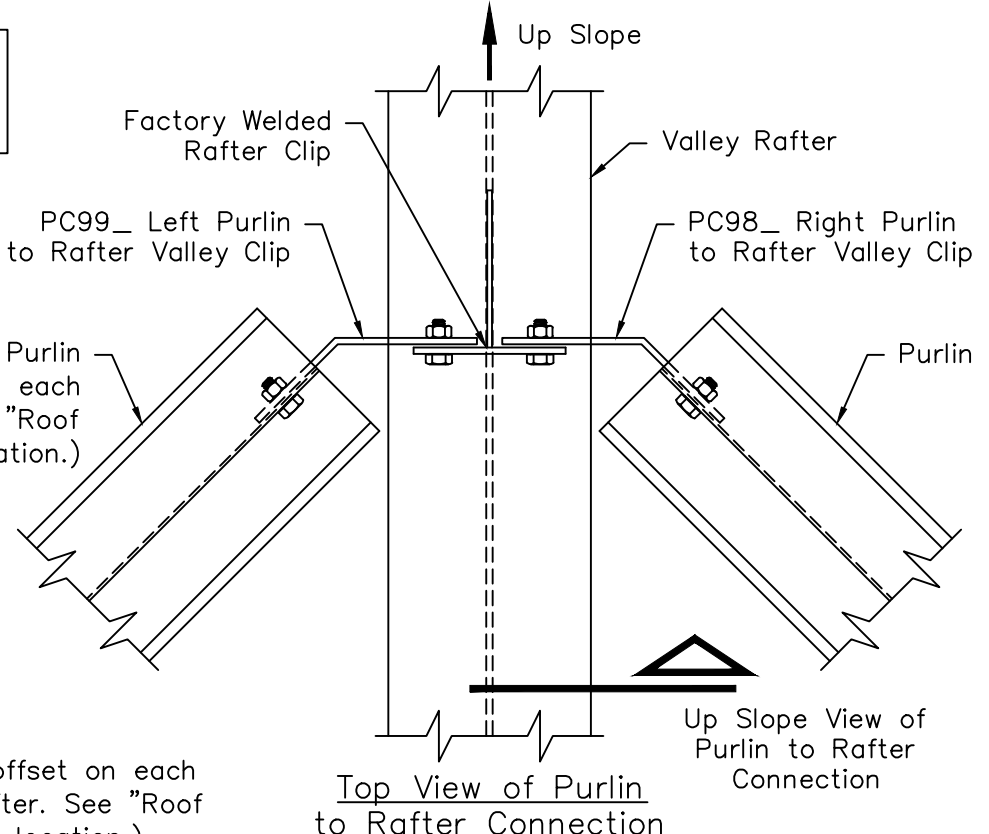

(Purlins may be offset on each side of Valley Rafter. See "Roof Framing Plan" for location.)

(Purlins may be offset on each side of Valley Rafter. See "Roof Framing Plan" for location.)

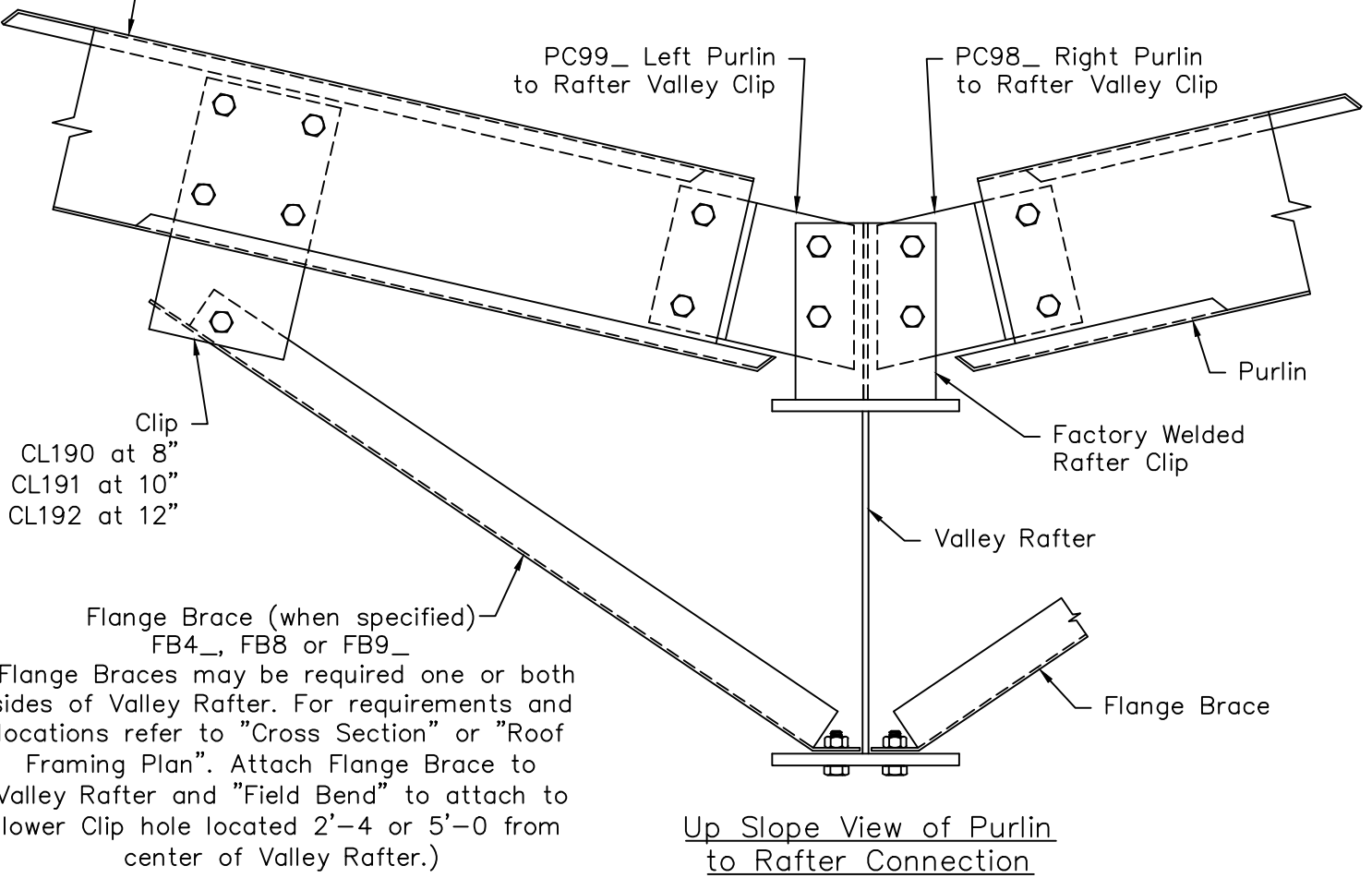

Up Slope View of Purlin to Rafter Connection