

Flush Transverse Partition - Flush Load Bearing Column at Slope Type 3 Connection with Column Extension to Purlin

Sheeting Angle RA1
Attach to each Purlin with
(1) Fastener #1B
 $\frac{1}{4}$ "-14 x $1\frac{1}{4}$ " DP3
(Field Notch at Shop Welded
Purlin Clips when Offset is 4")

Girt and Rafter
Offset 4" (w/8" Girts)
5" (w/10" Girts)
6" (w/12" Girts)

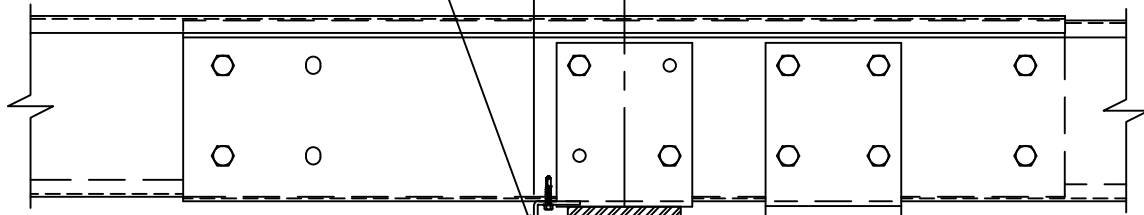

Clip PC83_
attach to Purlin
with (4) $\frac{1}{2}$ " ϕ Bolts

Rafter/Column shape
and connection will
vary, see "Frame
Cross Section" for
requirements.

(4) $\frac{3}{4}$ " ϕ A325 Bolts

Typical Flush Girt attachment, attach
with (2) $\frac{1}{2}$ " ϕ Bolts to Shop Welded
Clip (See "Transverse Partition
Framing Elevation" for locations)

Flush Partition Column
(See "Transverse Partition
Framing Elevation" for locations and Flange
Brace requirements, if required)

Sheeting Clip
CL292 or PC30_
(1) Fastener #12A
12-14 x 1" DP3
at each end

Partition Base Framing
Standard Base Angle RA1 shown,
may vary. (See "Transverse Partition
Framing Elevation" for requirement.)

Field Cut Partition
Base Framing at
Column

$\frac{1}{4}$ " ϕ Anchor (Min.)
60" o.c. (Max.)
Not by Bldg. Mfr.

Zee Girts shown, attachment
similar for Cee or Zee Girt
with outer flange toed up.

