

# AVP / PBA Light Transmitting Wall Panel Girt Front Leg Down

Light Transmitting Panels less than 10'-8" may require field cutting to length (see PW11003 to PW11007 for instructions).

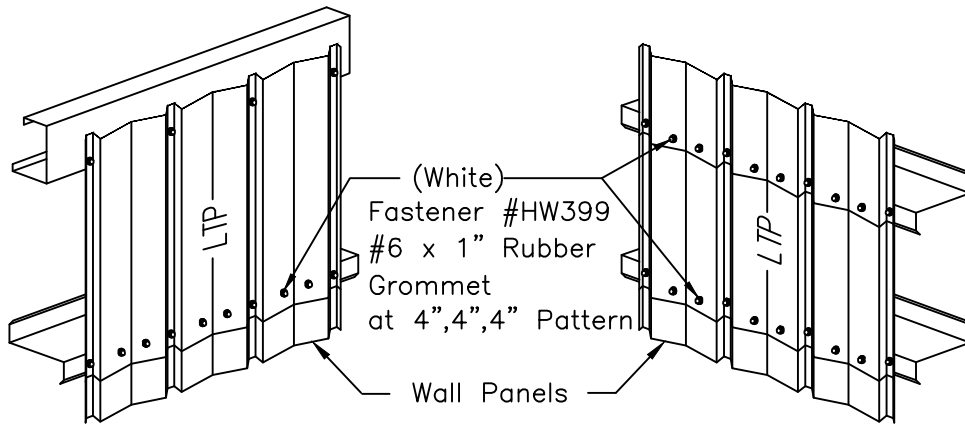

Wall Light Band At Eave

Wall Light Band Between Girts

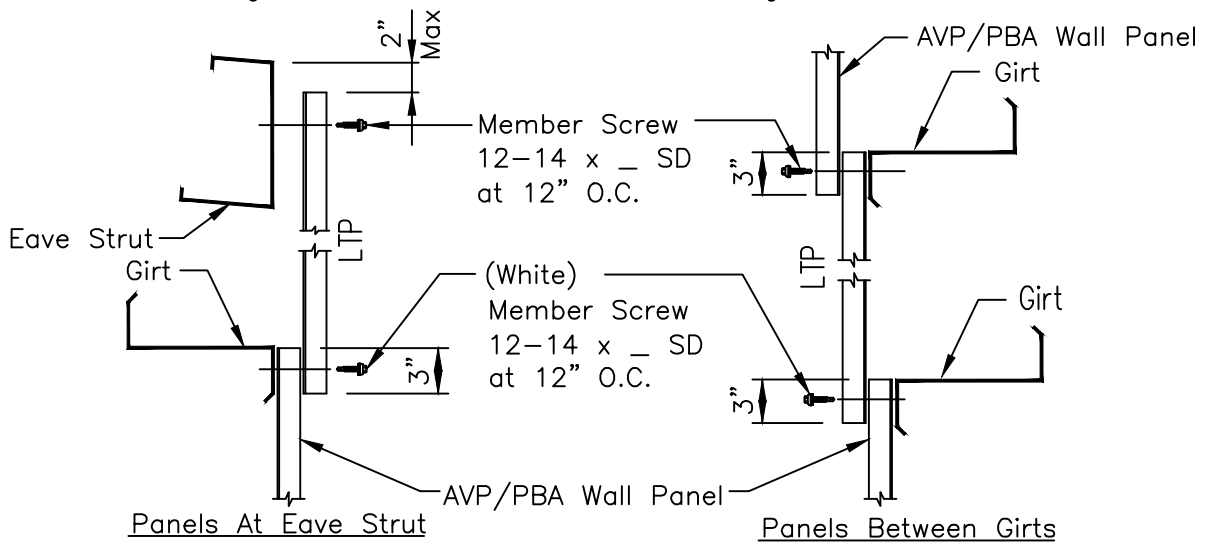

Panels At Eave Strut

Panels Between Girts

\*\* Not required for walls installed without insulation

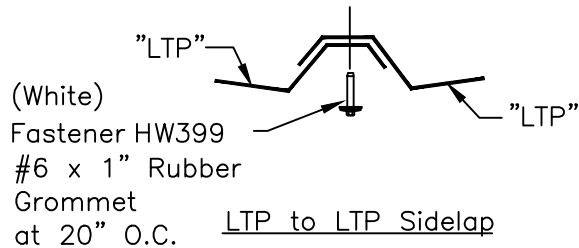

LTP to LTP Sidelap

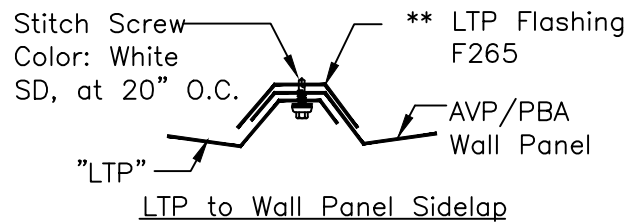

LTP to Wall Panel Sidelap

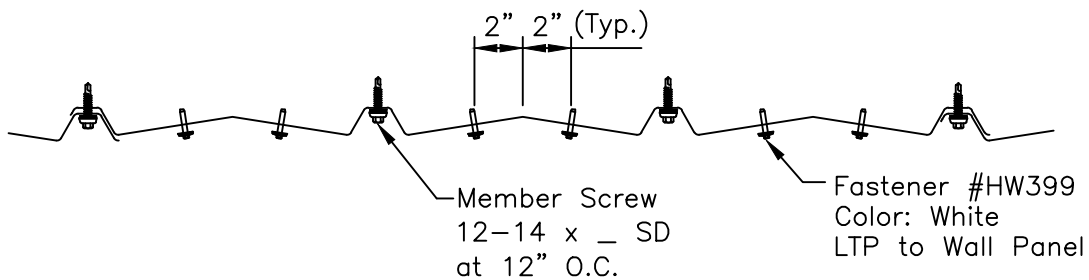

Member Screw  
12-14 x SD  
at 12" O.C.

Fastener #HW399  
Color: White  
LTP to Wall Panel