

Knock-In Bridging Installation

3:12 to 4 $\frac{1}{2}$:12 Single Row

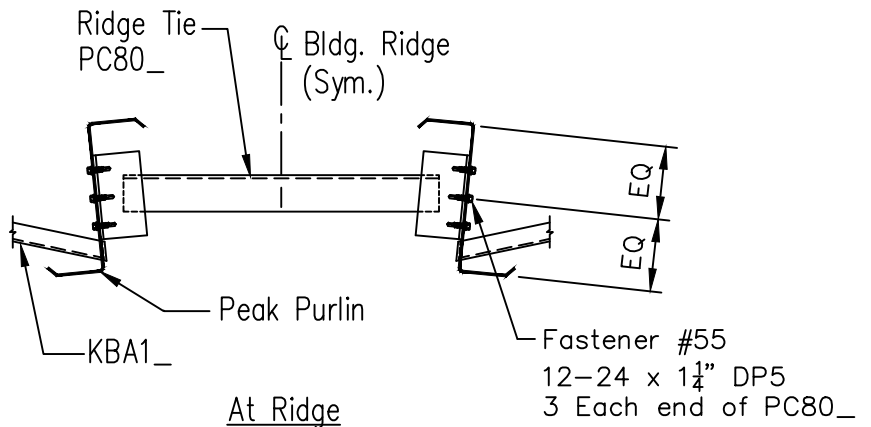
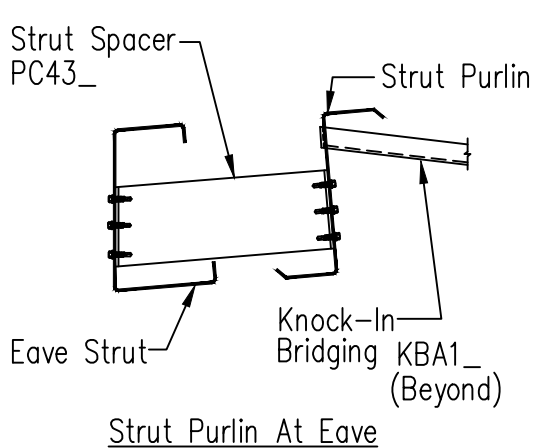

All fasteners shown are #1B
 $\frac{1}{4}$ "-14 x $\frac{1}{4}$ " DP3 unless noted

Note: The Bridging Angle will be installed from the bottom slot of the high side purlin to the top slot of the adjacent low side purlin.

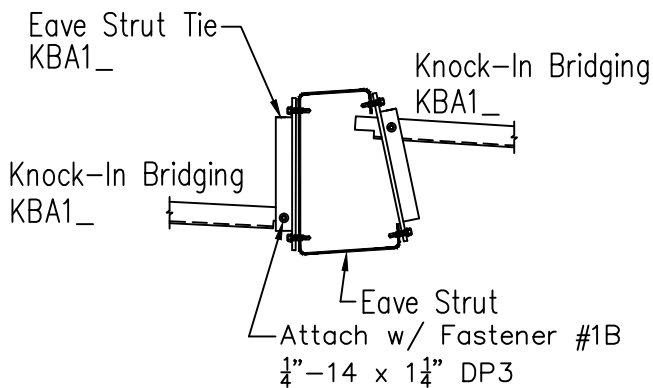
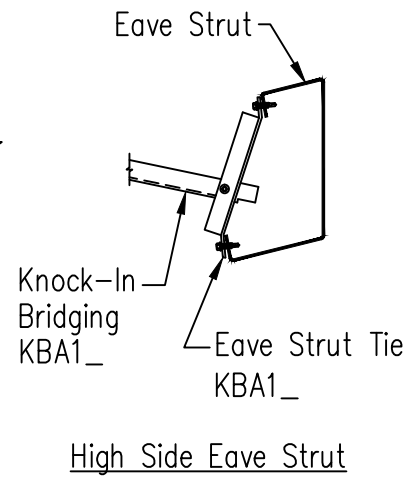
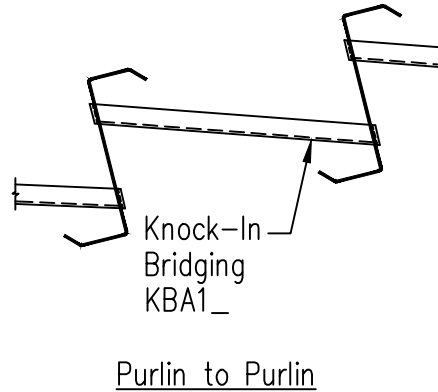
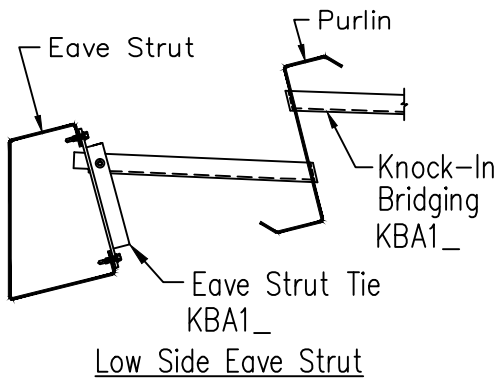

Continuous Roof
 Low Side Shown, High Side Similar

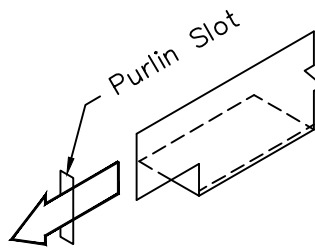

Step 1
 Insert Tab Into Slot

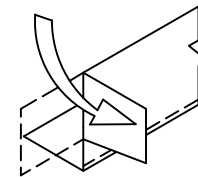

Step 2
 Bend Tab 90 Degrees

Note: The bridging must be inserted into the pre-punched slot in the Purlin as shown in Step 1 and the tab bent side ways for proper installation Step 2. The process must be complete for the bridging to function as designed.