

# ARCHITECTURAL/HORIZONTAL INSULATED METAL WALL PANEL

METL-SPAN INSULATED METAL PANELS

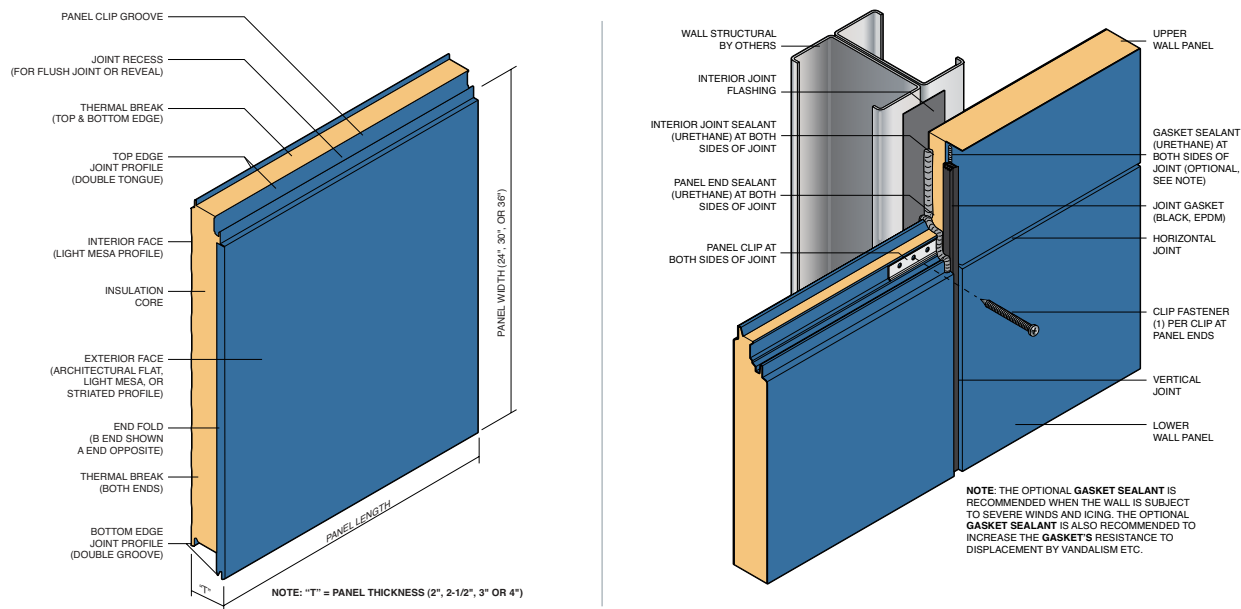

The Metl-Span **Architectural/Horizontal insulated metal wall panel** is ideal for high profile horizontal applications. Designed to install with concealed clips and fasteners in the side joint, Architectural/Horizontal wall panels provide maximum design flexibility and a beautiful high-tech appearance. The horizontal interlocking joint can be varied for visual impact. It may be ordered flush or with a  $\frac{3}{8}$ " deep reveal of  $\frac{1}{4}$ ",  $\frac{1}{2}$ ",  $\frac{3}{4}$ ", 1", 1  $\frac{1}{2}$ ", 2", 2  $\frac{1}{2}$ ", or 3" width. The panel ends are folded to eliminate the need for metal trim at the vertical butt joint. The joint is sealed with a black dry gasket to create a shadowline effect that can be emulated in the horizontal reveal.



## ARCHITECTURAL/HORIZONTAL INSULATED METAL WALL PANEL FEATURES

**Exterior Profile:** Architectural flat with flush or reveal horizontal joints

**Interior Profile:** Light Mesa nominal  $\frac{1}{16}$ " deep

**Panel Core:** Foamed-in-place, Non-CFC & zero ODP polyurethane, FM Class 1 approval

**Thermal Values:** K-factor, Btu in/ft<sup>2</sup> hr. °F @ 75°F (24°C) mean core temperature = 0.140. K-factor, Btu in/ft<sup>2</sup> hr. °F @ 40°F (4°C) mean core temperature = 0.126

**Module Width:** 24", 30", 36"

**Reveal Width:**  $\frac{1}{4}$ ",  $\frac{1}{2}$ ",  $\frac{3}{4}$ ", 1", 1  $\frac{1}{2}$ ", 2", 2  $\frac{1}{2}$ ", 3"

**Panel Thickness:** 2", 2  $\frac{1}{2}$ ", 3", 4"

**Panel Lengths:** Standard 8'-0" to 32'-0"

**Exterior Facings:** Stucco embossed, G-90 galvanized and/or AZ-50 aluminum-zinc coated steel in 22 Ga.

**Interior Facings:** Stucco embossed, G-90 galvanized and/or AZ-50 aluminum-zinc coated steel in 26 Ga., 24 Ga. and 22 Ga.

**Panel Joint:** Offset double tongue and groove with extended metal shelf for positive face fastening

**Fastening:** Fastener and clip concealed in the side joint

FM Approved Class 1 with no height restrictions.

## FINISHES & COLORS

A full range of exterior colors & coatings are available for the architectural market. For specific information about our available colors and coatings, visit us online for a comprehensive selection.

**METL-SPAN:** Pioneering Insulated Metal Panel Technology

1720 Lakepointe Drive, Suite #101, Lewisville, Texas 75057 • 877.585.9969 • FAX: 972.420.9382

[metlspan.com](http://metlspan.com) • Visit our website or call us today for a free architectural catalog and CAD CD-ROM.

© 2012 Metl-Span - A Division of NCI Group, Inc. All rights reserved. Printed in the U.S.A. METL-12-019-2-3-02